

ABACOA PLAT NO. 2

A Portion of Sections 13 and 14, Township 41 South, Range 42 East
Town of Jupiter, Palm Beach County, Florida

This Instrument prepared by James E. Park, P.S.M.
Williams, Hatfield & Stoner, Inc. - Engineers Surveyors Planners Environmental Scientists
1901 South Congress Avenue, Suite 150, Boynton Beach, Florida 33426

September, 1999

Sheet 4 of 13

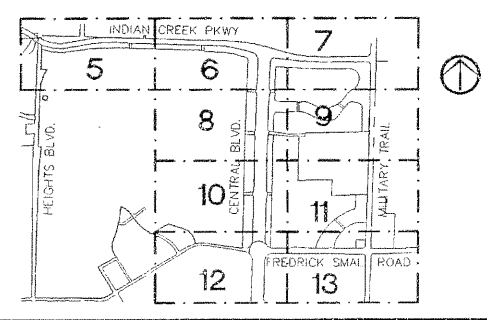

KEY MAP

